

## Brick, Stone & Block

- Design flexibility for building exteriors and signature interior spaces.
- Attractive curb appeal with three brick styles, five stone styles and one block style.
- The patented clip installation system creates a pocket of air between the panels and the substrate. This reduces moisture build up and enhances the integrity of the substrate.
- Panels are completely compatible with vinyl, wood, metal and cellular PVC trim accessories.
- Multi-layered coating process creates a lasting finish.
- 50-year limited transferable warranty on panels\*
- 15-year transferable limited finish warranty\*

## Sierra Premium™

- Sierra Premium™ panels are 60% thicker than other fiber cement shake panels. Thicker panels mean more distinctive appearance and deeper shadow lines.
- Factory primed and factory sealed on six sides.
- Withstands greater than 150 mph (3 sec. gusts) sustainable winds - ASTM E 330
- Less breakage during installation with thicker 1/2" panels.
- 30-year transferable limited warranty\*

## Sierra Premium™ Shake

- Deep grain and groove texture creates an authentic appearance for both residential and commercial applications.

- Available in primed, pre-finished in any color and 5 pre-finished stain colors. (Manufactured by Duckback Products, Inc. -12-year warranty\* on stain finish and 15-year warranty\* on paint finish)

## Sierra Premium™ Smooth

- Smooth lap siding provides design options for both residential and commercial applications.

- Available in two profile sizes: 7" and 8 3/4".

Vintage Brick	Newport Brick	Canyon Brick
18" (h) x 6' (l), 3/4" thick, 37.5 lbs. per panel	18" (h) x 6' (l), 3/4" thick, 38.75 lbs. per panel	18" (h) x 6' (l), 5/8" thick, 31.9 lbs. per panel
 White Wash  Alexandria Buff  Rustic Autumn	 Red-Buff  Rose-Red  Rose-Red  Red-Red	 Burnt Copper  Amber Wheat  Shale Brown
Field Stone	Quarry Stone	Cinderstone
18" (h) x 6' (l), 5/8" thick, 31.9 lbs. per panel	18" (h) x 6' (l), 5/8" thick, 31.9 lbs. per panel	18" (h) x 6' (l), 7/8" thick, 41.9 lbs. per panel
 Pepper Sand  Dusted Copper  Bronze Mist	 Speckled Brown  Desert Slate  Gray Mist	 Field Gray  Canyon Brown
Sandstone	Sandstone II	Architectural Block
18" (h) x 6' (l), 1" thick, 47.5 lbs. per panel	18" (h) x 6' (l), 3/4" thick, 37.5 lbs. per panel	18" (h) x 6' (l), 5/8" thick, 31.9 lbs. per panel
 Ash White  Gentle Gray  Autumn Brown  Sedona	 Autumn Brown  Gentle Gray  Desert Beige	 Gray  Sand  Primed
Sierra Premium™ Smooth	Sierra Premium™ Shake	
7" or 8 3/4" (h) x 10' (l), 1/2" thick, 7" - 18 lbs. per panel, 8 3/4" - 22.5 lbs. per panel	9" (h) x 8' (l), 1/2" thick, 18.6 lbs. per panel	
 7" Profile (shown lapped)  8 3/4" Profile (shown lapped)	 Redwood  Mahogany  Maple	 Cedar  Primed  Weathered Gray



Light Commercial



**Silica Dust Warning.** NICHHA products contain crystalline silica (a.k.a. sand, silicon dioxide), which is a common Earth's naturally occurring mineral. Inhalation of crystalline silica into the lungs and repeated exposure, can cause health disorder, such as silicosis, lung cancer, or a potentially death. Whenever drilling, cutting, sawing, sanding or abrading the product, users must observe the following safety practices. 1) Use best work practices to reduce airborne dust concentrations. 2) Work outdoors where feasible, otherwise use mechanical ventilation. 3) Everyone handling NICHHA's product or in the vicinity of others using NICHHA's product must wear safety glasses and properly fitted respirators, prior to handling NICHHA products. We require that users wear a NIOSH/OSHA approved respirator with a rating of N100, P100, or R100 in accordance with applicable government regulations and manufacturer instructions. All employers must comply with the OSHA PEL and ACGIH TLV-TWA. 4) Use a circular saw with dust collector for cutting. The dust collector must be connected to a HEPA vacuum. 5) Do not use compressed air for cleaning dust. 6) Warn others in area. These requirements are designed to help minimize exposure to crystalline silica. We also require that you read all instructions and warnings (including the MSDS) prior to using NICHHA's product. For further information or question, please consult the MSDS or your employer. FAILURE TO ADHERE TO OUR WARNINGS, MSDS, AND OTHER INSTRUCTIONS MAY LEAD TO SERIOUS PERSONAL INJURY OR DEATH.



Nichiha USA, Inc.

5855 Oakbrook Parkway, Suite P  
Norcross, GA 30093

Toll Free: 1.86 NICHHA 1 (1.866.424.4421)

P. 770.805.9466 F. 770.805.9467

www.NICHHA.com

\*See Nichiha Warranty for detailed information on terms, conditions and limitations.

\*Note: Printed material may not accurately depict actual product color.

©2006 Nichiha USA, Inc. All rights reserved. Printed in the USA. 08/06 PP N1530



## Nichiha Offers Light Commercial Owners, Architects, Contractors Tremendous Value

Nichiha fiber cement products combine a high level of quality with a low cost of installation to make a significant difference in light commercial projects bottom line. Nichiha textured fiber cement panels are visually unmatched in texture, beauty and quality and offer unparalleled design choices for light commercial properties. The Nichiha panels install simply by using the patented clip system. This system creates a pocket of air between the brick and stone panels and substrate that reduces moisture build-up, enhancing substrate integrity. Nichiha panels offer outstanding performance. Panels are resistant to rot, fungus, termites, withstand extreme weather conditions and will not crack or delaminate. Nichiha fiber cement products either meet or exceed all industry specifications and testing standards and are manufactured in our ISO 9001 certified manufacturing facilities.

## Nichiha Panels Can Be Installed Over Various Substrates



Metal Frame Construction

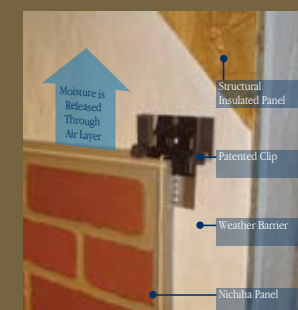

Structural Insulated Panels

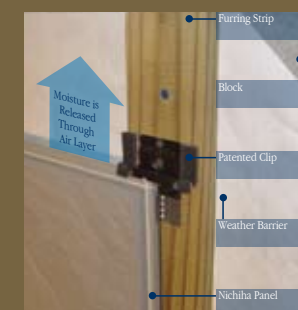

Concrete Masonry Units

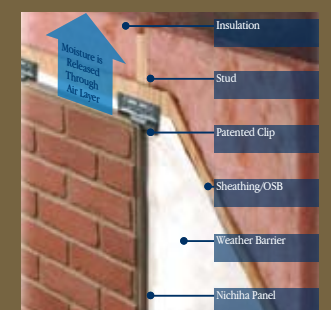

Wood Frame Construction